

MULTI-FUNCTION SPRAY GUN

MULTI-FUNCTION SPRAY GUN

Operation and safety notes

ΤΟΒΒΦΥΝΚΤΙΟΝ ΣΠΡΑΪΣΤΟΛΥ

Kazalási és biztonsági utalások

MULTIFUNKCIJSKI PRŠILNI NASTAVEK

Navodila za upravljanje in varnostna opozorila

MULTIFUNKČNÍ POSTŘIKOVACÍ HLAVICE

Pokyny pro obsluhu a bezpečnostní pokyny

MULTIFUNKČNÝ POSTREKOVÁČ

Pokyny pre obsluhu a bezpečnostné pokyny

MULTIFUNKCIONALNA VRTNA PRSKALICA

Upute za posluživanje i za Vašu sigurnost

MULTIFUNKCIONALNA PRSKALICA

Saveti o sastavljanju i bezbednosti

МУЛТИФУНКЦИОНАЛНА ПРСКАЛКА

Напомена за употреба и безбедност

DUSH SHUMĚFUNKSIONAL

Shënime lidhur me përdorimin dhe sigurinë

PISTOL MULTIFUNȚIONAL

Instrucțiuni de utilizare și de siguranță

МНОГОФУНКЦИОНАЛНА ПРЪСКАЧКА

Инструкции за обслужване и безопасност

ΠΙΣΤΟΛΙ ΕΚΤΟΞΕΥΣΗΣ ΝΕΡΟΥ ΠΟΛΥΛΕΙΤΟΥΡΓΙΩΝ

Υποδείξεις χειρισμού και ασφαλείας

MULTIFUNKTIONSBRÄUSE

Bedienungs- und Sicherheitshinweise

IAN 517166_2510

HU SI CZ HR
RS RO BG GR

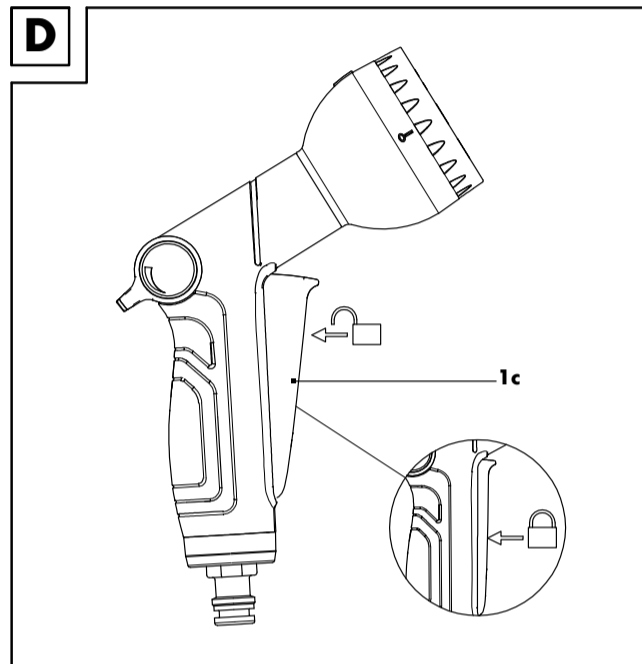
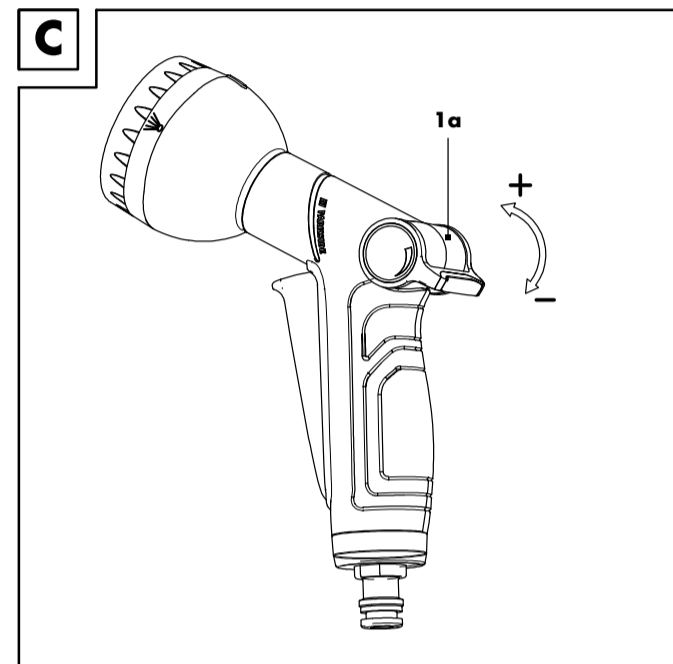

Technical data

Operating pressure: max. 4 bar

Included items

- 1 Multi-function spray gun
- 1 Operating instructions

Safety notices

Familiarise yourself with all the operating instructions and safety advice for the product before installation. When passing this product on to others, please be sure to include all its documentation.

CAUTION! RISK OF INJURY! Please ensure that no parts are damaged and that all parts are correctly assembled. Incorrect assembly could lead to injury. Damaged parts could impact safety and function.

WARNING! Do not grease or oil the nozzle, as this may clog the nozzle.
■ Only suitable for cold water irrigation.

WARNING! Do not aim the water stream at electrical equipment!

WARNING! Do not aim the water stream at persons or animals!

WARNING! WATER NOT POTABLE!
Never drink water which has passed through this product.

WARNING! Close the tap after every use.

- For outdoor use only.
- Do not operate the device if it is damaged.

GB/CY

Any damage or defects already present at the time of purchase must be reported without delay after unpacking the product.

Should the product show any fault in materials or manufacture within 3 years from the date of purchase, we will repair or replace it – at our choice – free of charge to you. The warranty period is not extended as a result of a claim being granted. This also applies to replaced and repaired parts.

This warranty becomes void if the product has been damaged, or used or maintained improperly.

The warranty covers material or manufacturing defects. This warranty does not cover product parts subject to normal wear and tear, thus considered consumables (e.g. batteries, rechargeable batteries, tubes, cartridges), nor damage to fragile parts, e.g. switches or glass parts.

Warranty claim procedure

So that your request can be processed quickly, please observe the following instructions:

For all inquiries, please have the receipt and item number (IAN 517166_2510) ready as proof of purchase.

The article number can be taken from the identification label on the product, engraving on the product, the front cover of your manual (at the bottom left), or the sticker on the back or bottom of the product.

If malfunctions or other defects arise, first contact the service department indicated below by phone or email.

You can then send a product recorded as defective to the communicated service address postage-free, making sure to enclose proof of purchase (receipt) and information on the details of the defect and when it occurred.

You can download and view this and numerous other manuals at parkside-diy.com. This QR code takes you directly to parkside-diy.com. Choose your country and use the search screen to search for

GB/CY

the operating instructions. Entering the item number (IAN) 517166_2510 takes you to the operating instructions for your item.



PDF ONLINE
parkside-diy.com

Service

GB Service Great Britain
Tel.: 08000518970
Contact form on parkside-diy.com
IAN 517166_2510

CY Service Cyprus
Tel.: 80094242
Contact form on parkside-diy.com
IAN 517166_2510

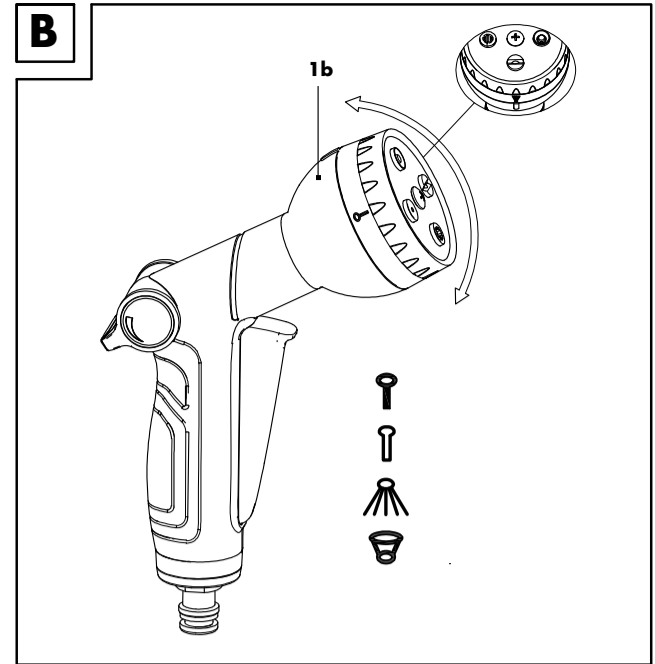

List of pictogram used	
	Safety Information
	Instruction for use
	Before using for the first time, read the instruction carefully.
	This symbol indicates that the product is UV resistant.
	This symbol indicates that the product is weather resistant.

MULTI-FUNCTION SPRAY GUN

Intended use

This product is suitable to irrigate garden- and patio areas. The product is not intended for commercial use.

Description of parts and features

- 1 Spray gun
- 1a Slide control
- 1b Spray gun head
- 1c Trigger lock
- 1d Adapter

After use

- Press the trigger lock **1c** to release it if it is locked.
- Turn off the water supply.
- Disconnect the spray gun **1** from hose connector with water stop.
- Clean the product as described under "Cleaning and care".

Cleaning and care

- WARNING!** All repairs shall only be carried out by the manufacturer, its service agent or similarly qualified persons.
- Hazards can arise due to improper maintenance.
- Use a slightly dampened, non-fluffing cloth to clean the product.
- Dry well after each use and store in a dry and frost-free place.

Disposal

The packaging is made entirely of recyclable materials, which you may dispose of at local recycling facilities.

Contact your local refuse disposal authority for more details of how to dispose of your worn-out product.

Warranty

The product has been manufactured to strict quality guidelines and meticulously examined before delivery. In the event of material or manufacturing defects you have legal rights against the retailer of this product. Your legal rights are not limited in any way by our warranty detailed below.

The warranty for this product is 3 years from the date of purchase. The warranty period begins on the date of purchase. Keep the original sales receipt in a safe location as this document is required as proof of purchase.

GB/CY

GB/CY

GB/CY

A használt piktogramok listája	
	Biztonsági információk
	Használati útmutató
	Az első használat előtt figyelmesen olvassa el az útmutatót.
	Ez a szimbólum azt jelzi, hogy a termék UV-álló.
	Ez a szimbólum azt jelzi, hogy a termék időjárásálló.

TÖBBFUNKCIÓS LOCSOLÓPISZTOLY

Rendeltetészerű használat

Ez a termék kertek és teraszok öntözésére alkalmas. Ez a termék nem kereskedelmi használatra készült.

Az alkatrészek és funkciók megnevezése

- 1 Szórópisztoly
- 1a Billenőkapcsoló
- 1b Szórópisztoly fej
- 1c Rögztető
- 1d Adapter

Műszaki adatok

Üzemi nyomás: max. 4 bar

GB/CY

HU

